

**PATENTED**  
**M395751**  
**M287204**

## SUPER OPEN QUICK ACTION VISE

### Model: HSAC-160

- Patented **MULTI-POWER SYSTEM** provides extremely high clamping force of **0~4500kg**.
- No risk of loss of clamping pressure.
- No risk of oil leakage like Hydraulic Vises.
- More compact than Hydraulic Vises.
- Body has **ONE-PIECE CONSTRUCTION** for high rigidity and precision.
- **ANGLE-LOCK MECHANISM** provides downward pressure on Jaw to ensure parallel clamping.
- Both surfaces of Slideways are **HEAT TREATED**.
- Large opening capacity up to **300mm**.

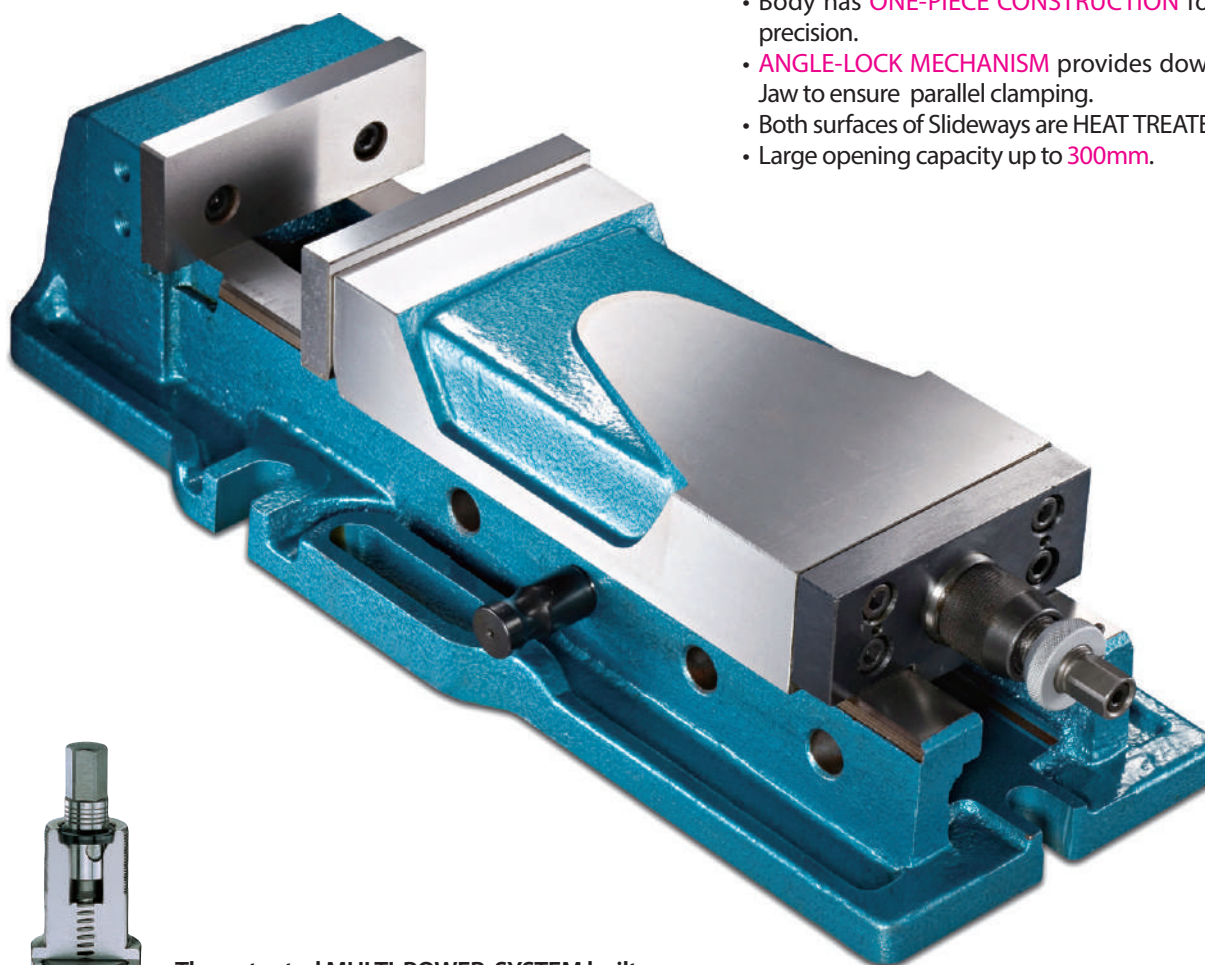

The patented MULTI-POWER SYSTEM built of **HIGH GRADE BEARING STEEL** provides extremely high clamping pressure. The pressure is more consistent and eliminates all leakage and maintenance problems associated with Hydraulic Vises.

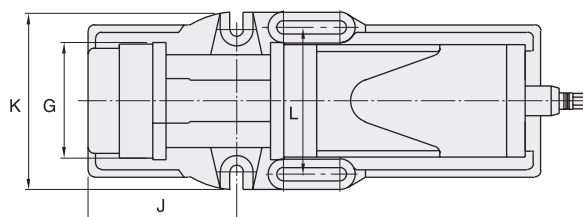
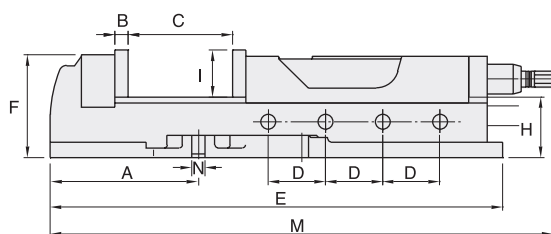

### SPECIFICATIONS (Material: FCD 60 Ductile Iron. Hardness: HRC 50°)

Unit: mm

| Model    | A   | B  | C   | D  | E   | F   | G   | H  | I  | J   | K   | L   | M   | N  | Weight (kg) |
|----------|-----|----|-----|----|-----|-----|-----|----|----|-----|-----|-----|-----|----|-------------|
| HSAC-160 | 200 | 15 | 300 | 77 | 610 | 139 | 158 | 82 | 58 | 200 | 240 | 190 | 840 | 18 | 58          |